

DRAWING FINISH GOOD

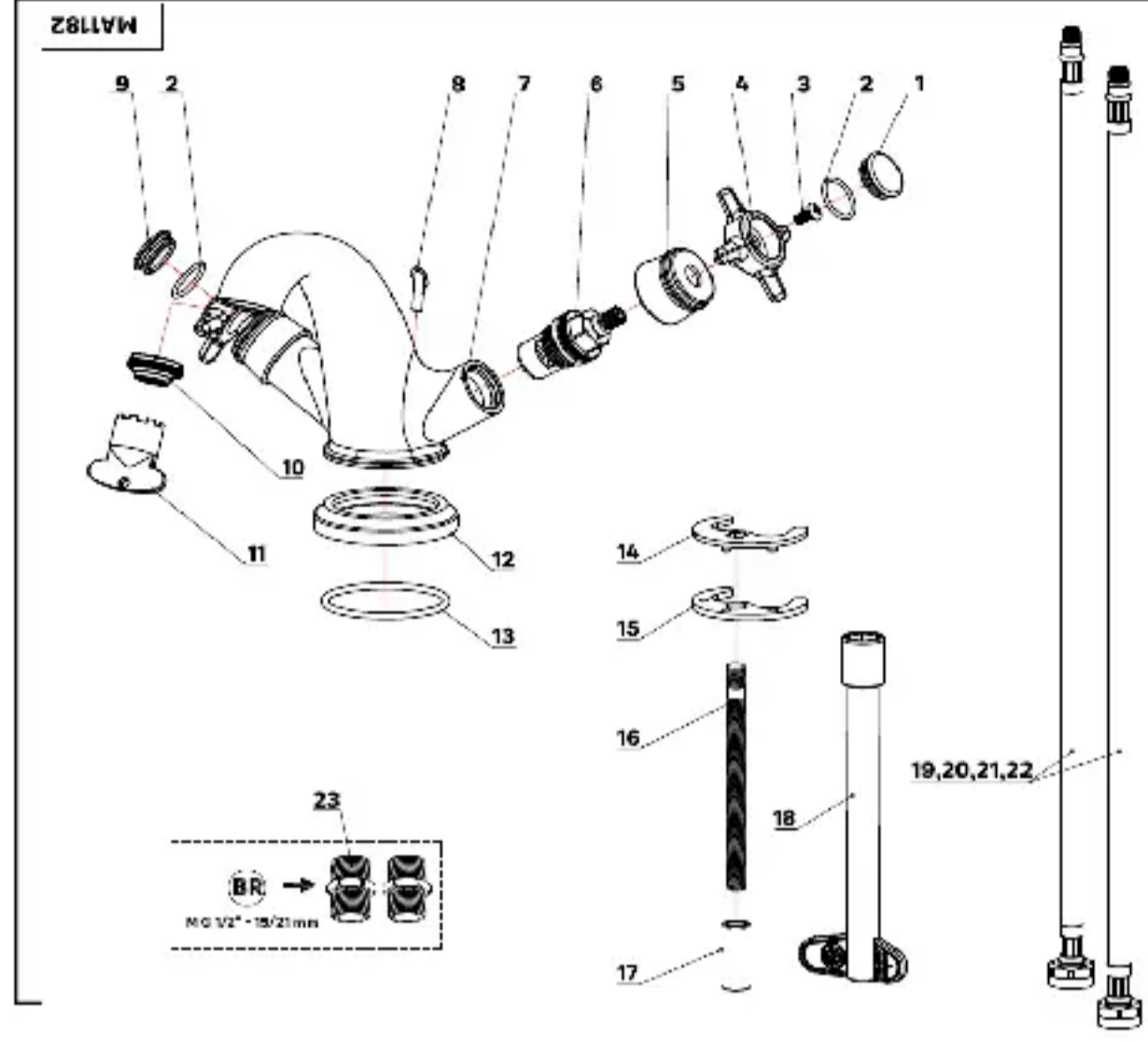

ITEM	NAME	QTY	MANUFACTURER NAME	Code No.	SIZE / WEIGHT/DIAMETER	MATERIAL AND GRADE	FINISHING
1	Plug	1	GAOAO	q43178	4	Ceramic	
2	O ring	2	GAOAO	m19126N		EPDM	
3	Screw	2	GAOAO	g24384T	2	Stainless steel	
4	Handle	2	GAOAO	f06448CJA	50	Zinc alloy	CHROME 3 PLATING
5	Cover	2	GAOAO	t09472CJA	6	ABS	CHROME 3 PLATING
6	Head work	2	WANHAI	24KK-1	29	PA+ceramic	
7	Body	1	GAOAO	a03050CJSA	606	Brass	CHROME 3 PLATING
8	Cover	1	GAOAO	t36085CJA	1	ABS	CHROME 3 PLATING
9	Plug	1	GAOAO	q43177	4	Ceramic	
10	Aerator insert	1	NEOPERL	40.8454.010	3	POM	
11	NEOPERL KEY	1	NEOPERL	09.9170.000	4	POM	
12	Base	1	GAOAO	f38274CJA	71	Zinc alloy	CHROME 3 PLATING
13	O ring	1	GAOAO	m19249N	2	NBR	
14	Gasket	1	GAOAO	k26820R	2	NBR	
15	Metal gasket	1	GAOAO	g42069	20	Stainless steel	
16	Threaded Rod	1	GAOAO	g24403	43	Stainless steel	
17	Nut	1	GAOAO	g23371	12	Stainless steel	
18	ADEO key	1	GAOAO	w24402BK	33.5	PA6-T GF50	
19	Flexible hose - hot water - F G 3/8" - 12/17mm	1	JL	DN6JLE38M8 - 45	42	Stainless steel	
20	Flexible hose - cold water - F G 3/8" - 12/17mm	1	JL	DN6JLE38M8 - 45	42	Stainless steel	
21	Flexible hose - hot water - F G 1/2" - 15/21mm	1	JL	DN6JLE12M8 - 45	45	Stainless steel	
22	Flexible hose - cold water - F G 1/2" - 15/21mm	1	JL	DN6JLE12M8 - 45	45	Stainless steel	
23	Adapter	2	GAOAO	c49112E-2	28	Brass	